

COMPONENTS OF CONTRACT PLANS SET

ROADWAY
SIGNING AND PAVEMENT MARKINGS

(A DETAILED INDEX APPEARS ON THE KEY SHEET OF EACH COMPONENT)

STATE OF FLORIDA
DEPARTMENT OF TRANSPORTATION
SIGNING AND PAVEMENT MARKING PLANS

FINANCIAL PROJECT ID 448613-2-54-01
JEFFERSON COUNTY 54)
JEFFERSON Co. ROAD No. 149
BOSTON HWY

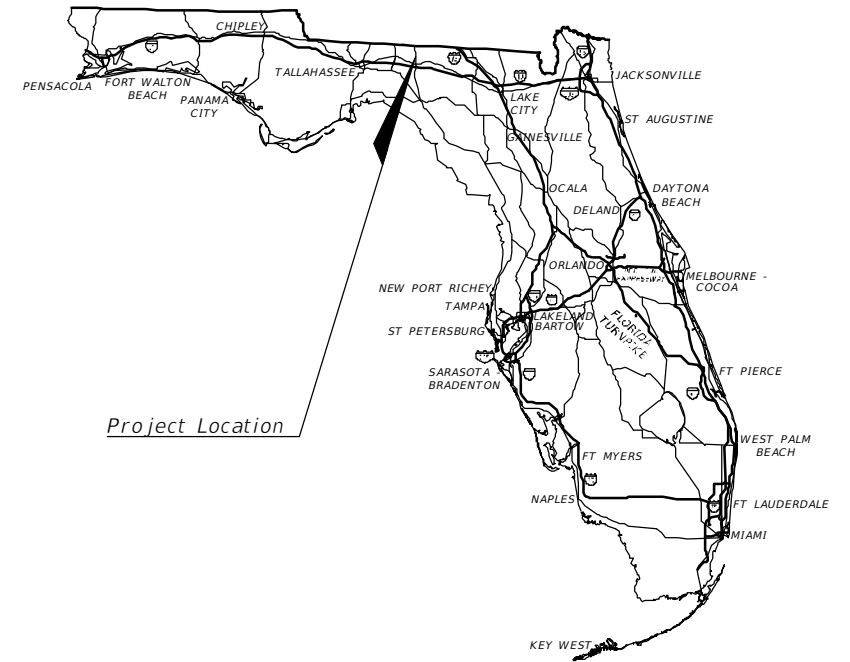

INDEX OF SIGNING AND PAVEMENT MARKING PLANS

SHEET NO.	SHEET DESCRIPTION
S-1	KEY SHEET
S-2	SUMMARY OF QUANTITIES
S-3 - S-15	SIGNAGE & PAVEMENT MARKING PLAN

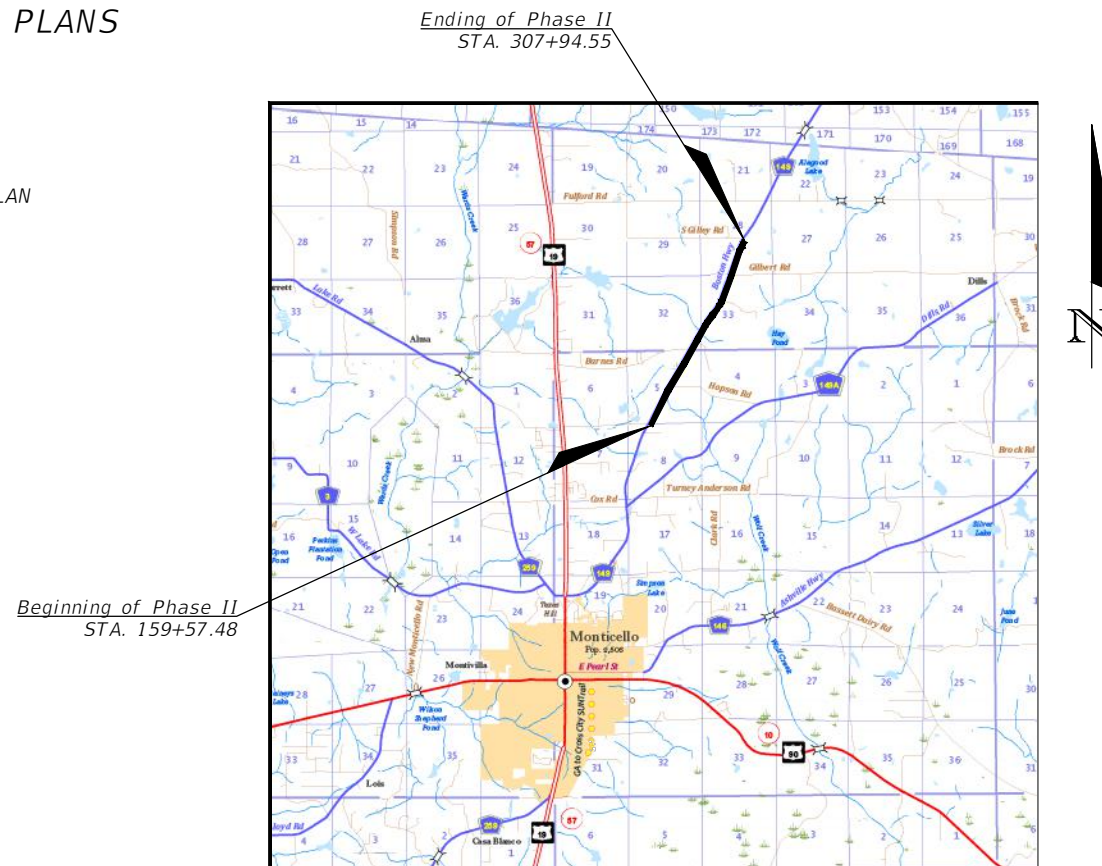

THIS ITEM HAS BEEN DIGITALLY SIGNED AND SEALED BY

ON THE DATE ADJACENT TO THE SEAL
SIGNATURE MUST BE VERIFIED ON ANY ELECTRONIC COPIES

SIGNING AND PAVEMENT MARKING PLANS
ENGINEER OF RECORD:

Lloyd Jack Husband
P.E. NO.: 69169
Southeastern Consulting Engineers, Inc (SCE)
120 Hwy 71
Wewahitchka, FL 32465

JEFFERSON CO.
PROJECT MANAGER:
Shannon Metty

CONSTRUCTION CONTRACT NO.	FISCAL YEAR	SHEET NO.
	26	S-1

GOVERNING STANDARD PLANS:
Florida Department of Transportation, FY2025-26 Standard plans for Road and Bridge Construction and applicable Interim Revisions (Irs).

Standard Plans for Road Construction and associated Irs are available at the following website:
<http://www.fdot.gov/design/Standardplans.shtm>

APPLICABLE IRs:

Standard Plans for Bridge Construction are included in the Structures Plans Component.

GOVERNING STANDARD SPECIFICATIONS:
Florida Department of Transportation, FY 2025/26 Standard Specifications for Road and Bridge Construction at the following website:
<http://www.fdot.gov/programmanagement/Implemented/SpecBooks>

THE OFFICIAL RECORD OF THIS SHEET IS THE ELECTRONIC FILE DIGITALLY SIGNED AND SEALED UNDER RULE 61G15-23.004, F.A.C.

SIGNING AND PAVEMENT MARKINGS				
PAY ITEM NUMBER	DESCRIPTION	UNIT	ESTIMATED QUANTITY	FINAL QUANTITY
700-1-111	SINGLE POST SIGN, F&I GROUND MOUNT, UP TO 12 SF	EA	5.00	
700-1-600	SINGLE POST SIGN, REMOVE	EA	5.00	
706-1-3	RAISED PAVEMENT MARKER, TYPE B Y/Y	EA	667	
711-16-101	THERMOPLASTIC, STANDARD, WHITE, SOLID, 6"	GM	5.55	
711-16-201	THERMOPLASTIC, STANDARD-OTHER SURFACES, YELLOW, SOLID, 6"	GM	4.70	
711-16-231	THERMOPLASTIC, STANDARD-OTHER SURFACES, YELLOW, SKIP, 6"	GM	0.34	

REVISIONS				LLOYD JACK HUSBAND, P.E. P.E. LICENSE NUMBER 69169 SCF, INC. P.O. BOX 141 WEWAHITCHKA, FLORIDA 32465	STATE OF FLORIDA DEPARTMENT OF TRANSPORTATION			<i>SUMMARY OF QUANTITIES</i>	SHEET NO.
DATE	DESCRIPTION	DATE	DESCRIPTION		ROAD NO.	COUNTY	FINANCIAL PROJECT ID		S-2
---	---				CR 149	JEFFERSON	448613-2-54-01		

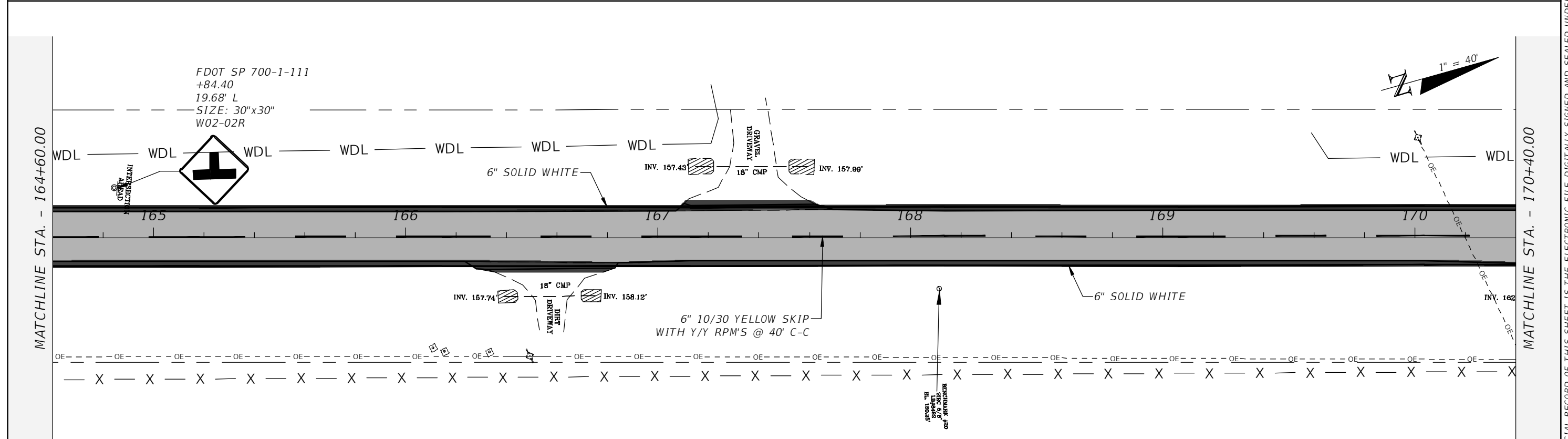
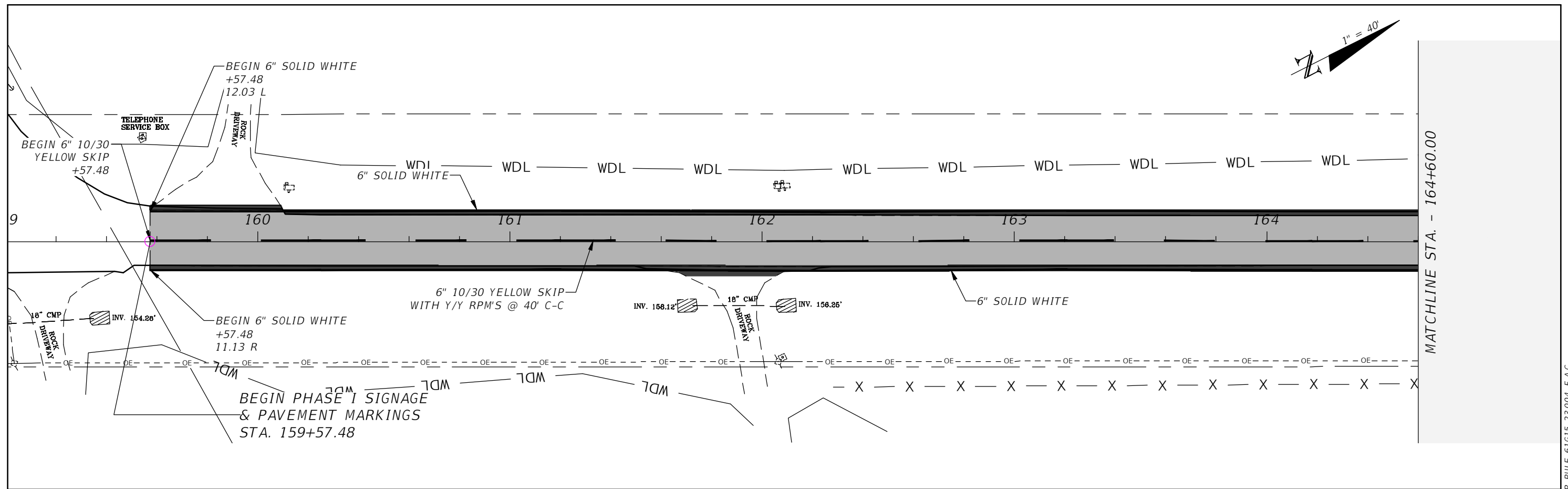

REVISIONS			
DATE	DESCRIPTION	DATE	DESCRIPTION

LLOYD JACK HUSBAND, P.E.
P.E. LICENSE NUMBER 69169
SCF, INC.
120 N. HWY 71
WEWAHITCHKA, FL 32456

STATE OF FLORIDA DEPARTMENT OF TRANSPORTATION		
ROAD NO.	COUNTY	FINANCIAL PROJECT ID
CR 149	JEFFERSON	448613-2-54-01

**SIGNAGE & PAVEMENT
MARKING PLAN**

SHEET NO.
S-3

THE OFFICIAL RECORD OF THIS SHEET IS THE ELECTRONIC FILE DIGITALLY SIGNED AND SEALED UNDER RULE 61G15-23.004, F.A.C.

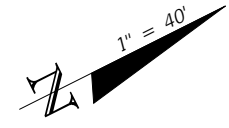

MATCHLINE STA. - 170+40.00

MATCHLINE STA. - 176+20.00

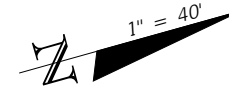
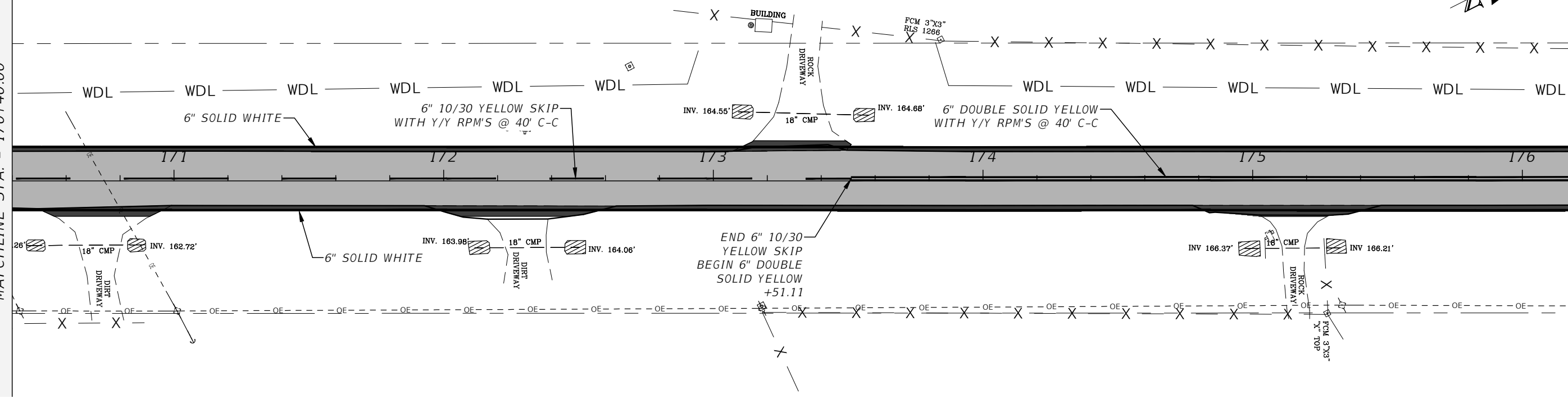

MATCHLINE STA. - 176+20.00

MATCHLINE STA. - 182+00.00

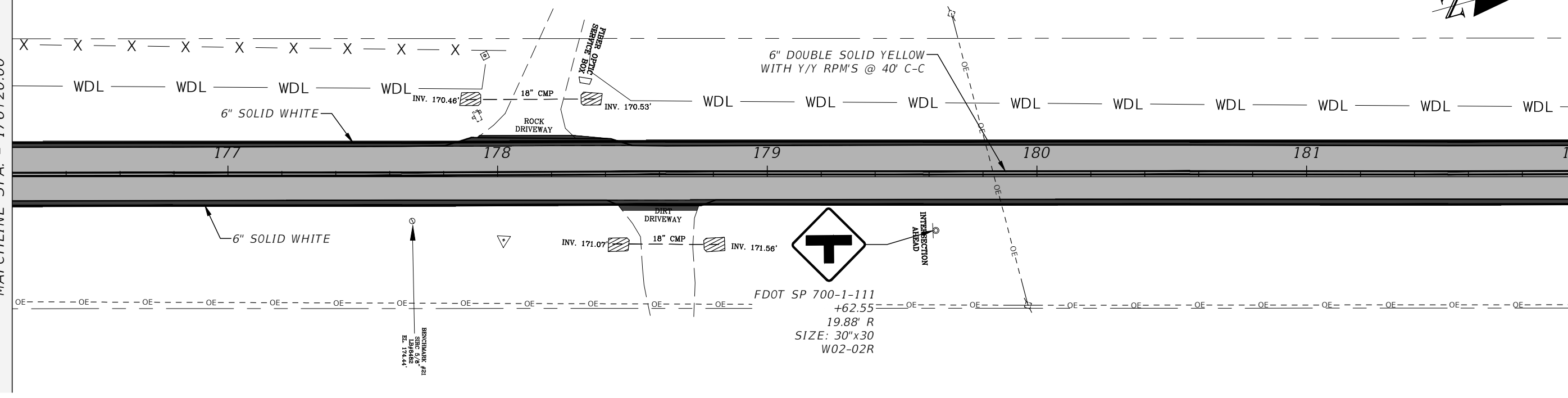

REVISIONS			
DATE	DESCRIPTION	DATE	DESCRIPTION

LLOYD JACK HUSBAND, P.E.
 P.E. LICENSE NUMBER 69169
 SCE, INC.
 120 N. HWY 71
 WEWAHITCHKA, FL 32456

STATE OF FLORIDA DEPARTMENT OF TRANSPORTATION		
ROAD NO.	COUNTY	FINANCIAL PROJECT ID
CR 149	JEFFERSON	448613-2-54-01

**SIGNAGE & PAVEMENT
MARKING PLAN**

SHEET NO.
5-4

THE OFFICIAL RECORD OF THIS SHEET IS THE ELECTRONIC FILE DIGITALLY SIGNED AND SEALED UNDER RULE 61G15-23.004, F.A.C.

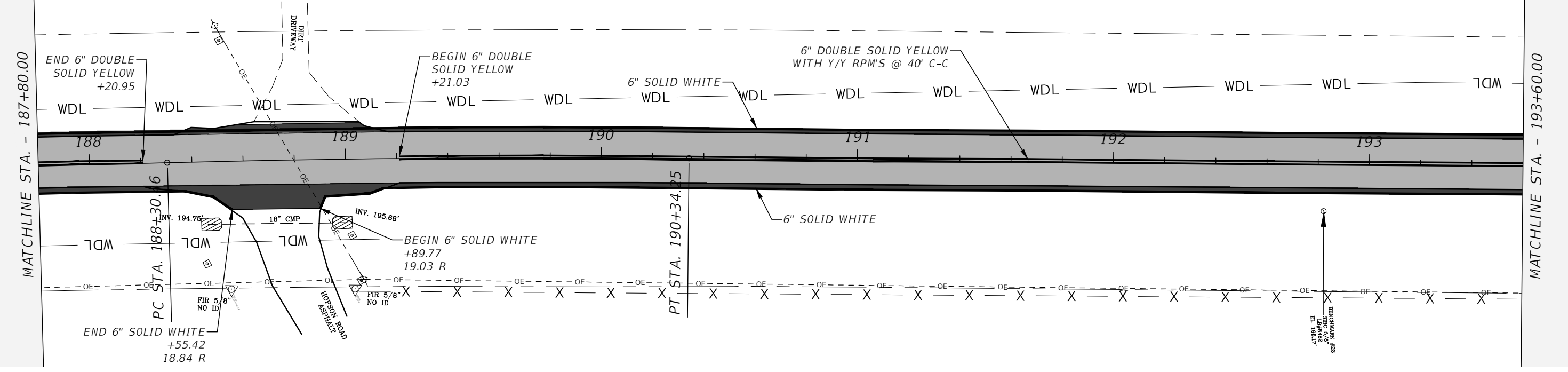
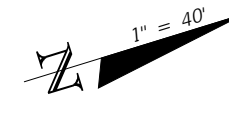
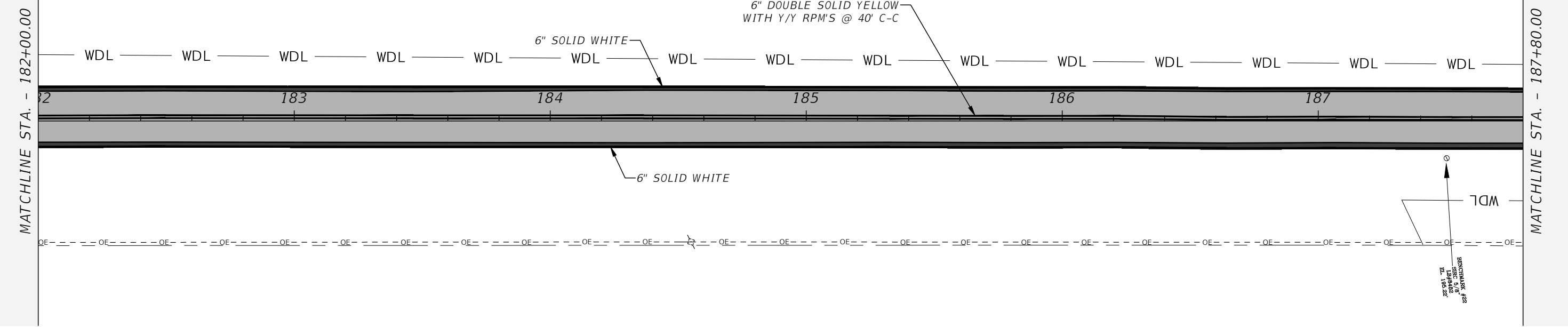
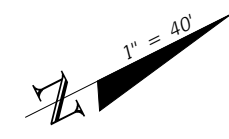

REVISIONS				LLOYD JACK HUSBAND, P.E. P.E. LICENSE NUMBER 69169 SCE, INC. 120 N. HWY 71 WEWAHITCHKA, FL 32456	STATE OF FLORIDA DEPARTMENT OF TRANSPORTATION			SHEET NO. S-5
DATE	DESCRIPTION	DATE	DESCRIPTION		ROAD NO.	COUNTY	FINANCIAL PROJECT ID	
---	---	---	---		CR 149	JEFFERSON	448613-2-54-01	

THE OFFICIAL RECORD OF THIS SHEET IS THE ELECTRONIC FILE DIGITALLY SIGNED AND SEALED UNDER RULE 61G15-23.004, F.A.C.

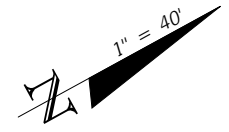

MATCHLINE STA. - 193+60.00

MATCHLINE STA. - 199+40.00

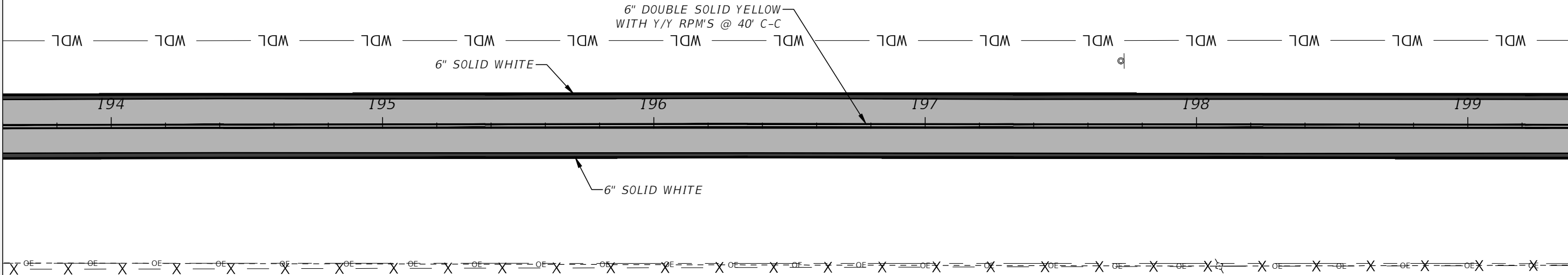

MATCHLINE STA. - 199+40.00

MATCHLINE STA. - 205+20.00

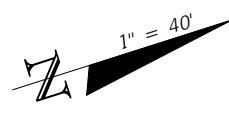
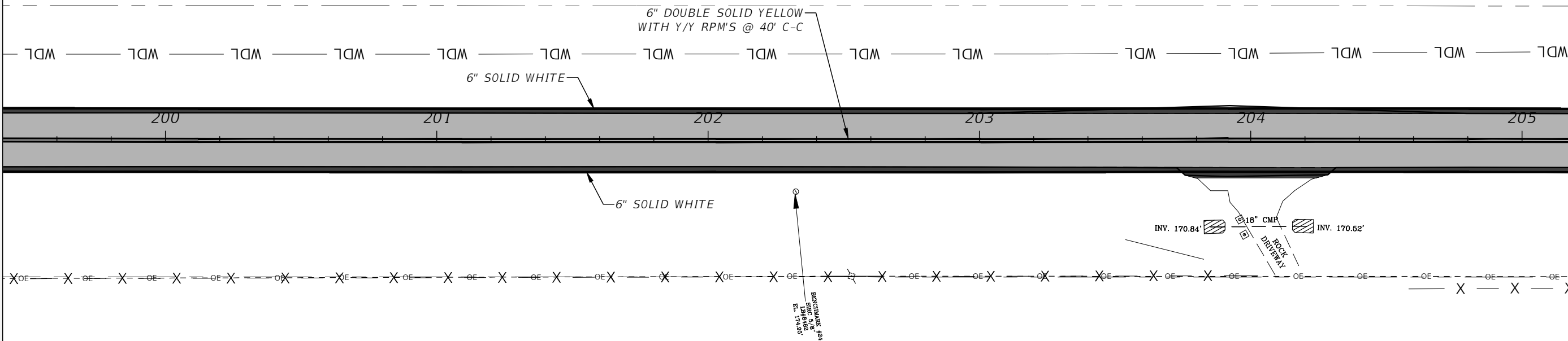

REVISIONS			
DATE	DESCRIPTION	DATE	DESCRIPTION
---	---	---	---

LLOYD JACK HUSBAND, P.E.
 P.E. LICENSE NUMBER 69169
 SCE, INC.
 120 N. HWY 71
 WEWAHITCHKA, FL 32456

STATE OF FLORIDA DEPARTMENT OF TRANSPORTATION		
ROAD NO.	COUNTY	FINANCIAL PROJECT ID
CR 149	JEFFERSON	448613-2-54-01

**SIGNAGE & PAVEMENT
MARKING PLAN**

SHEET NO.
5-6

THE OFFICIAL RECORD OF THIS SHEET IS THE ELECTRONIC FILE DIGITALLY SIGNED AND SEALED UNDER RULE 61G15-23.004, F.A.C.

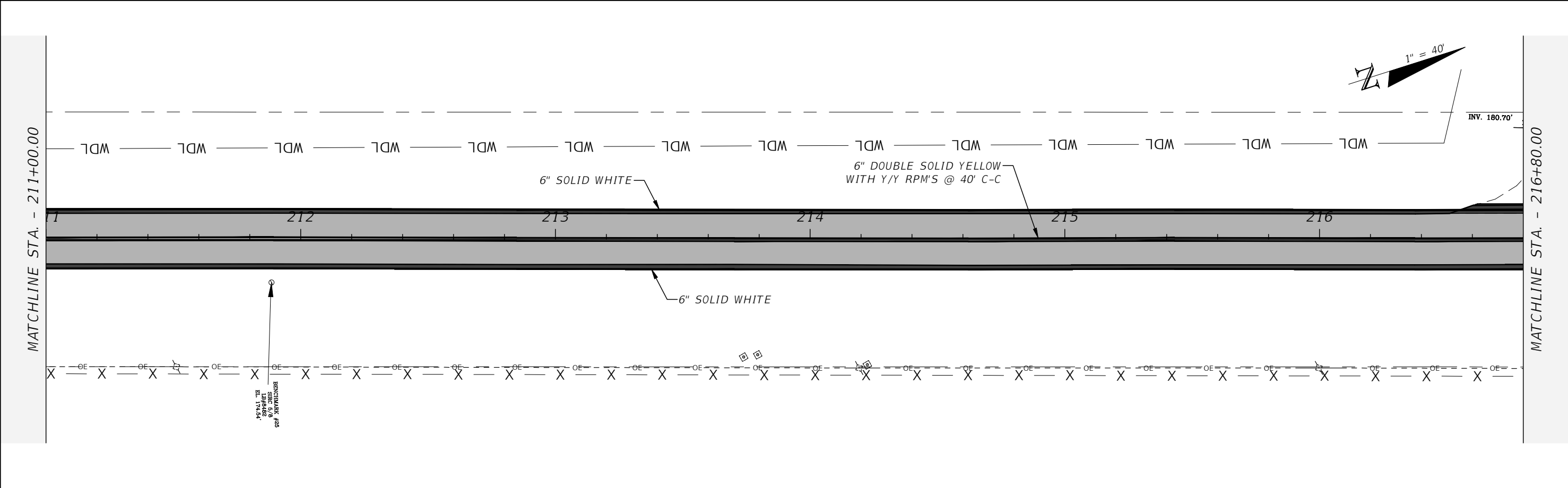
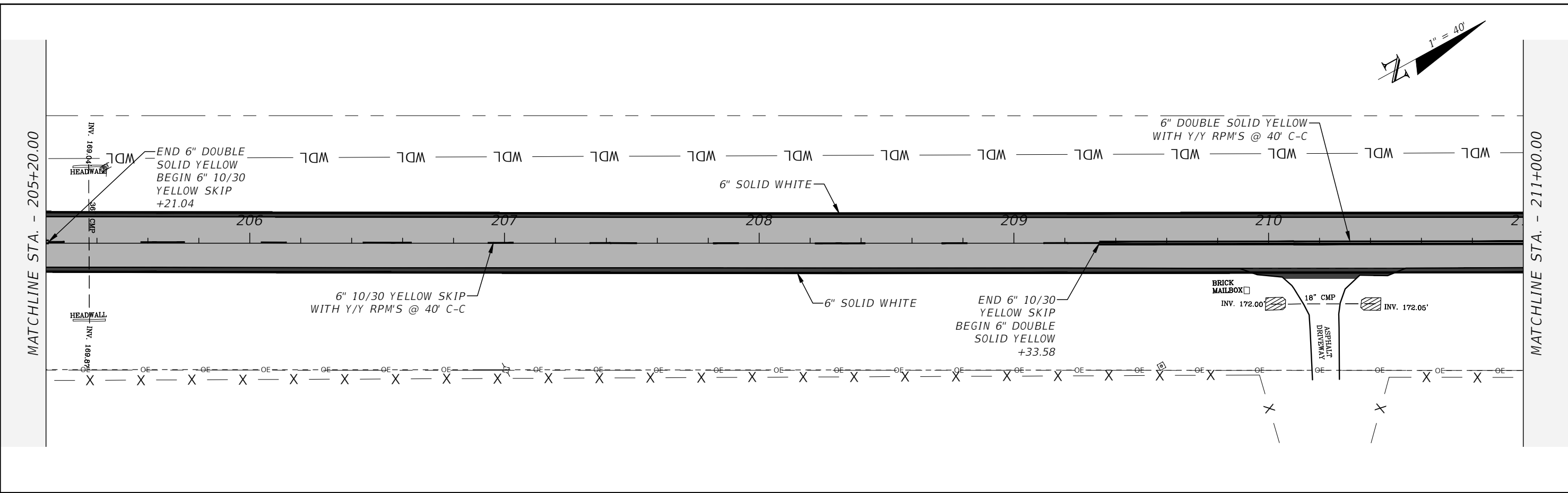
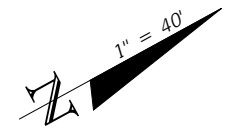

THE OFFICIAL RECORD OF THIS SHEET IS THE ELECTRONIC FILE DIGITALLY SIGNED AND SEALED UNDER RULE 61G15-23.004, F.A.C.

REVISIONS				LLOYD JACK HUSBAND, P.E. P.E. LICENSE NUMBER 69169 SCE, INC. 120 N. HWY 71 WEWAHITCHKA, FL 32456	STATE OF FLORIDA DEPARTMENT OF TRANSPORTATION			SIGNAGE & PAVEMENT MARKING PLAN	SHEET NO. 5-7
DATE	DESCRIPTION	DATE	DESCRIPTION		ROAD NO.	COUNTY	FINANCIAL PROJECT ID		
---	---	---	---		CR 149	JEFFERSON	448613-2-54-01		

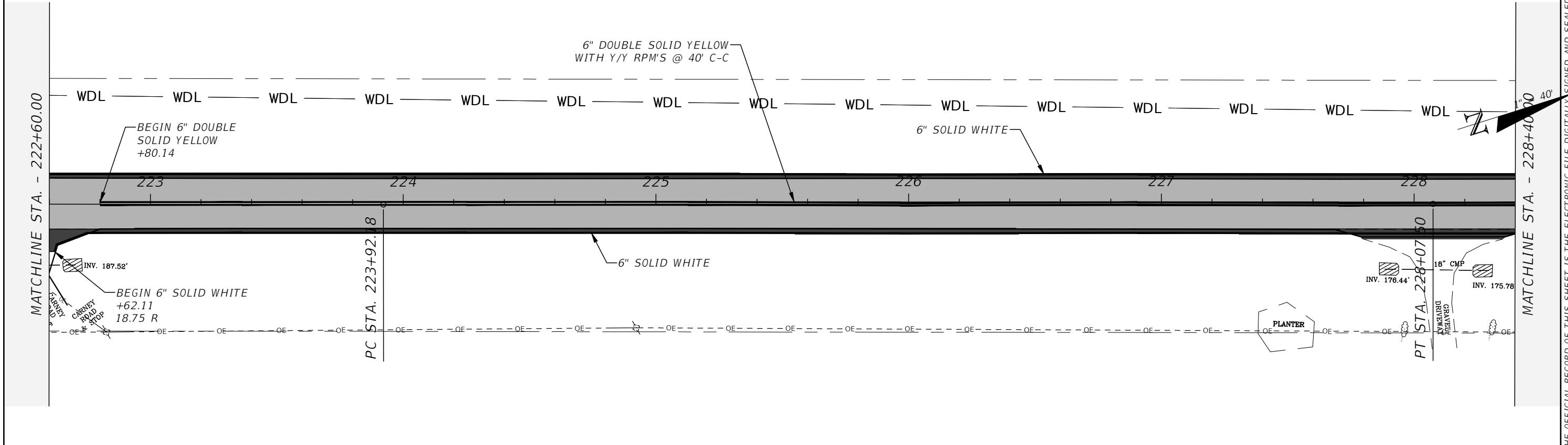
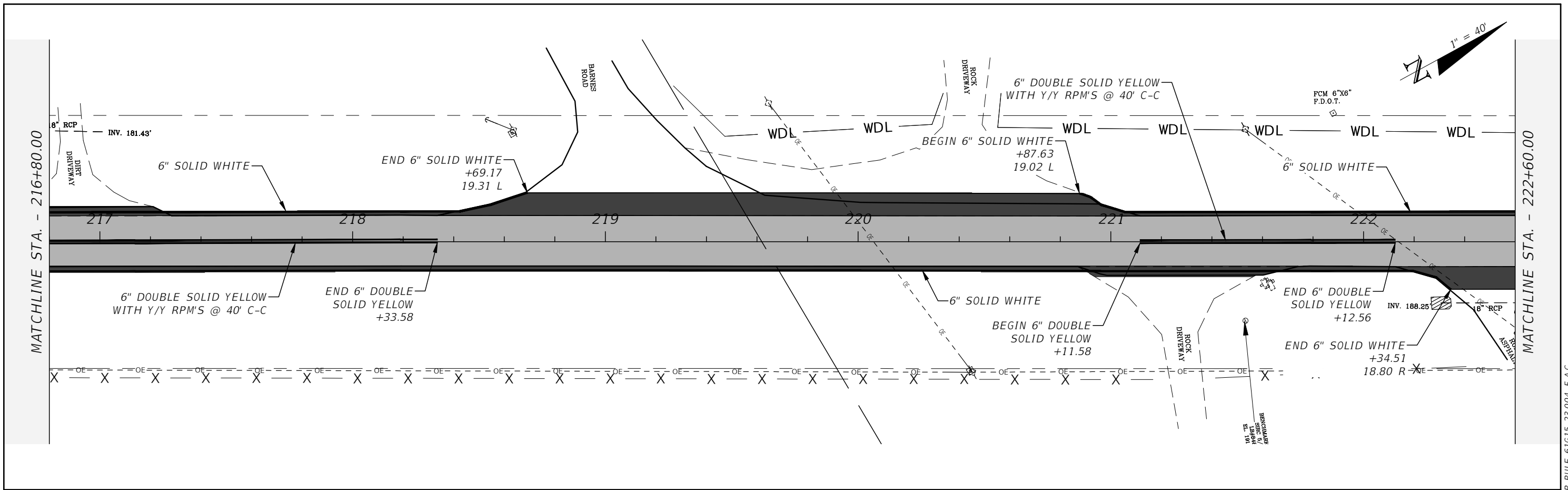

REVISIONS			
DATE	DESCRIPTION	DATE	DESCRIPTION

LLOYD JACK HUSBAND, P.E.
P.E. LICENSE NUMBER 69169
SCE, INC.
120 N. HWY 71
WEWAHITCHKA, FL 32456

STATE OF FLORIDA DEPARTMENT OF TRANSPORTATION		
ROAD NO.	COUNTY	FINANCIAL PROJECT ID
CR 149	JEFFERSON	448613-2-54-01

**SIGNAGE & PAVEMENT
MARKING PLAN**

SHEET NO.
5-8

THE OFFICIAL RECORD OF THIS SHEET IS THE ELECTRONIC FILE DIGITALLY SIGNED AND SEALED UNDER RULE 61G15-23.004, F.A.C.

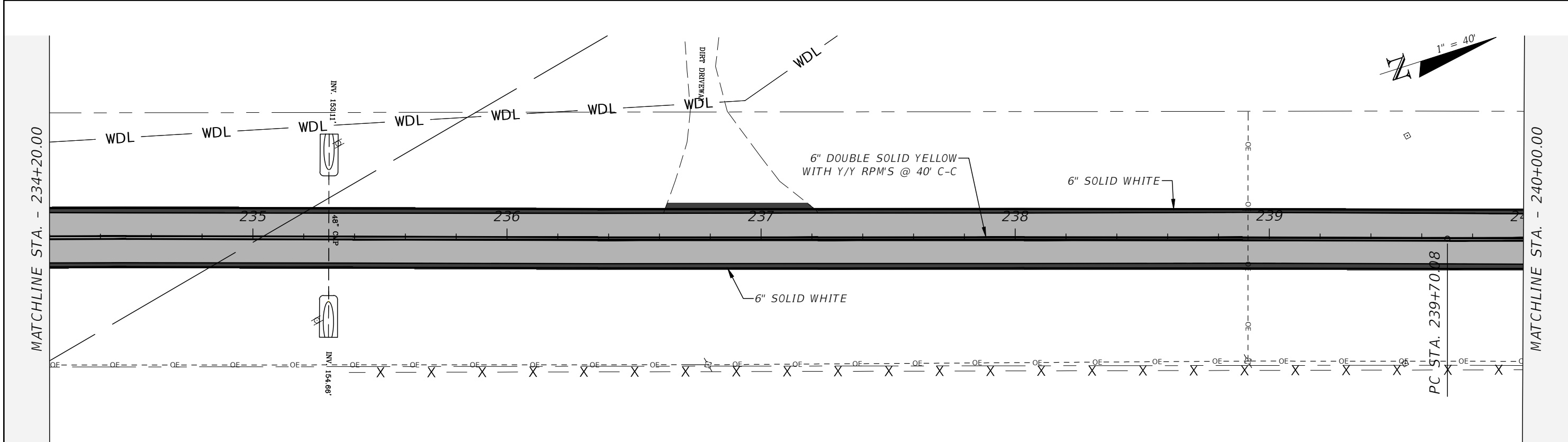
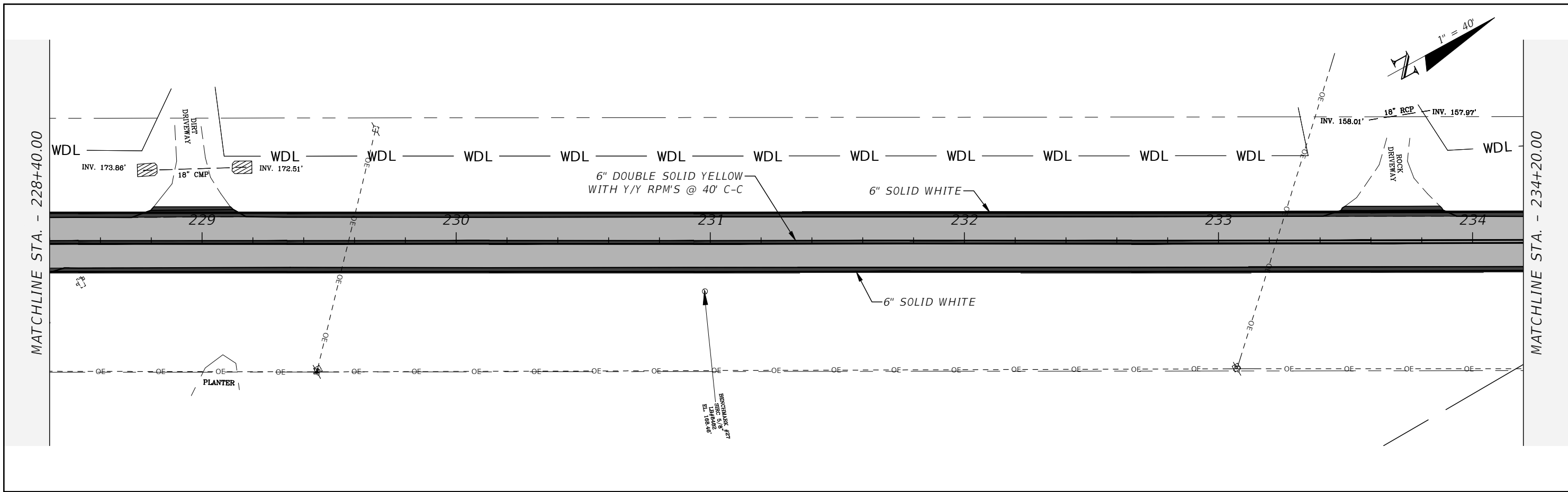

REVISIONS			
DATE	DESCRIPTION	DATE	DESCRIPTION
---	---	---	---

LLOYD JACK HUSBAND, P.E.
P.E. LICENSE NUMBER 69169
SCE, INC.
120 N. HWY 71
WEWAHITCHKA, FL 32456

STATE OF FLORIDA DEPARTMENT OF TRANSPORTATION		
ROAD NO.	COUNTY	FINANCIAL PROJECT ID
CR 149	JEFFERSON	448613-2-54-01

**SIGNAGE & PAVEMENT
MARKING PLAN**

SHEET NO.
5-9

THE OFFICIAL RECORD OF THIS SHEET IS THE ELECTRONIC FILE DIGITALLY SIGNED AND SEALED UNDER RULE 61G15-23.004, F.A.C.

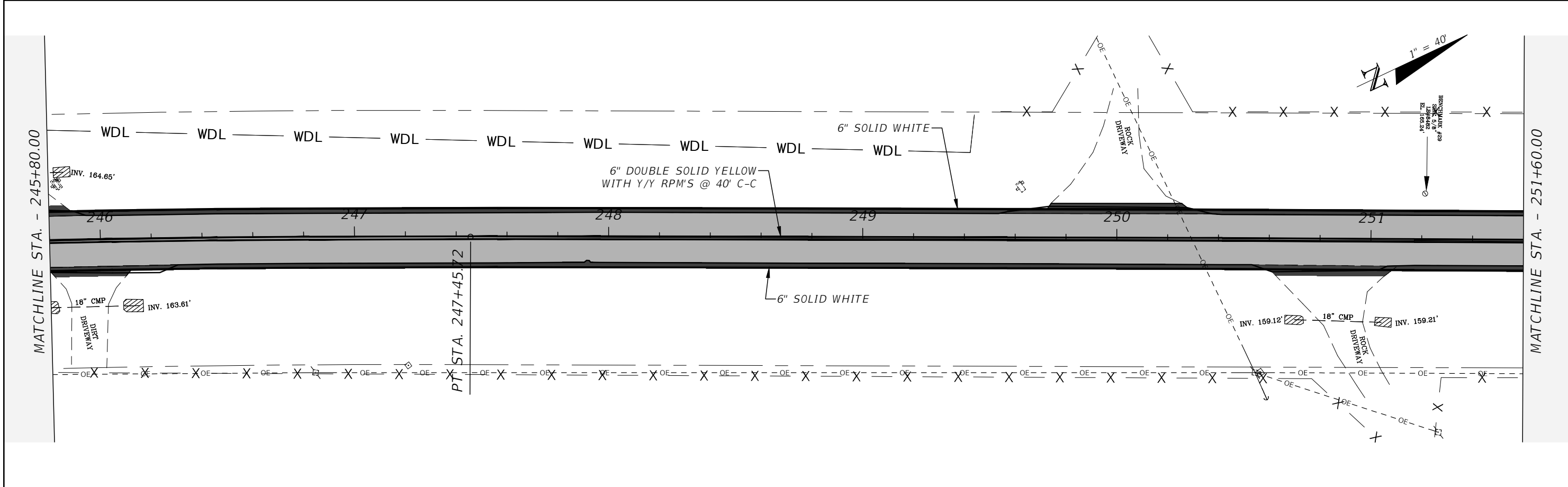
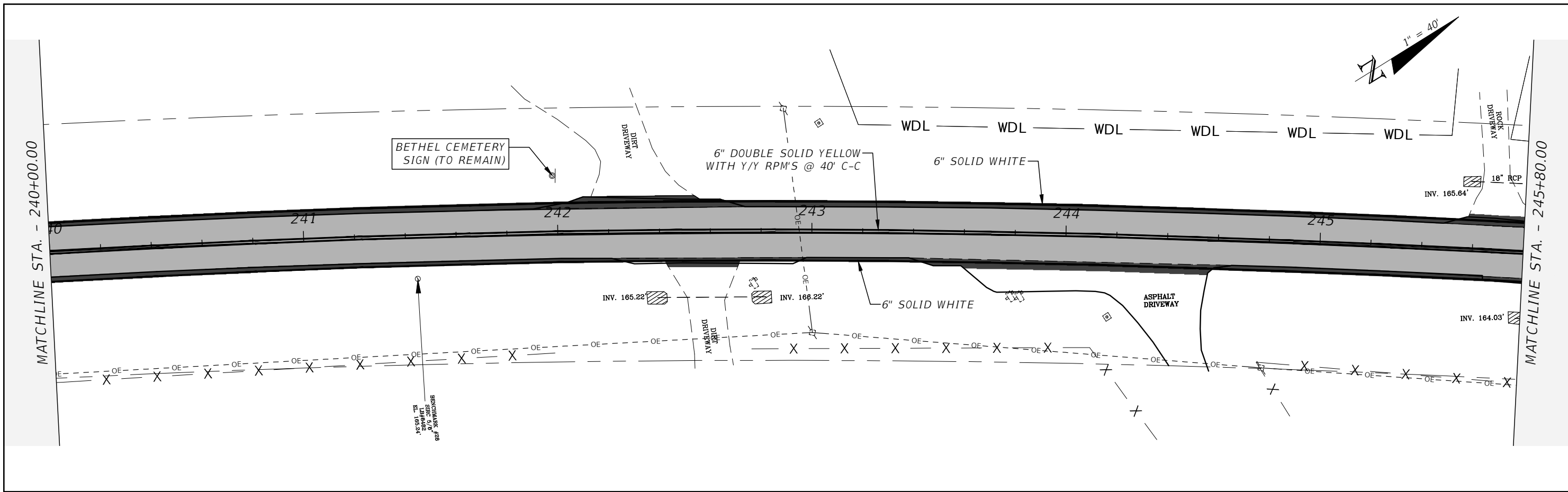

REVISIONS				LLOYD JACK HUSBAND, P.E. P.E. LICENSE NUMBER 69169 SCE, INC. 120 N. HWY 71 WEWAHITCHKA, FL 32456	STATE OF FLORIDA DEPARTMENT OF TRANSPORTATION			SIGNAGE & PAVEMENT MARKING PLAN	SHEET NO. 5-10
DATE	DESCRIPTION	DATE	DESCRIPTION		ROAD NO.	COUNTY	FINANCIAL PROJECT ID		
---	---	---	---		CR 149	JEFFERSON	448613-2-54-01		

THE OFFICIAL RECORD OF THIS SHEET IS THE ELECTRONIC FILE DIGITALLY SIGNED AND SEALED UNDER RULE 61G15-23.004, F.A.C.

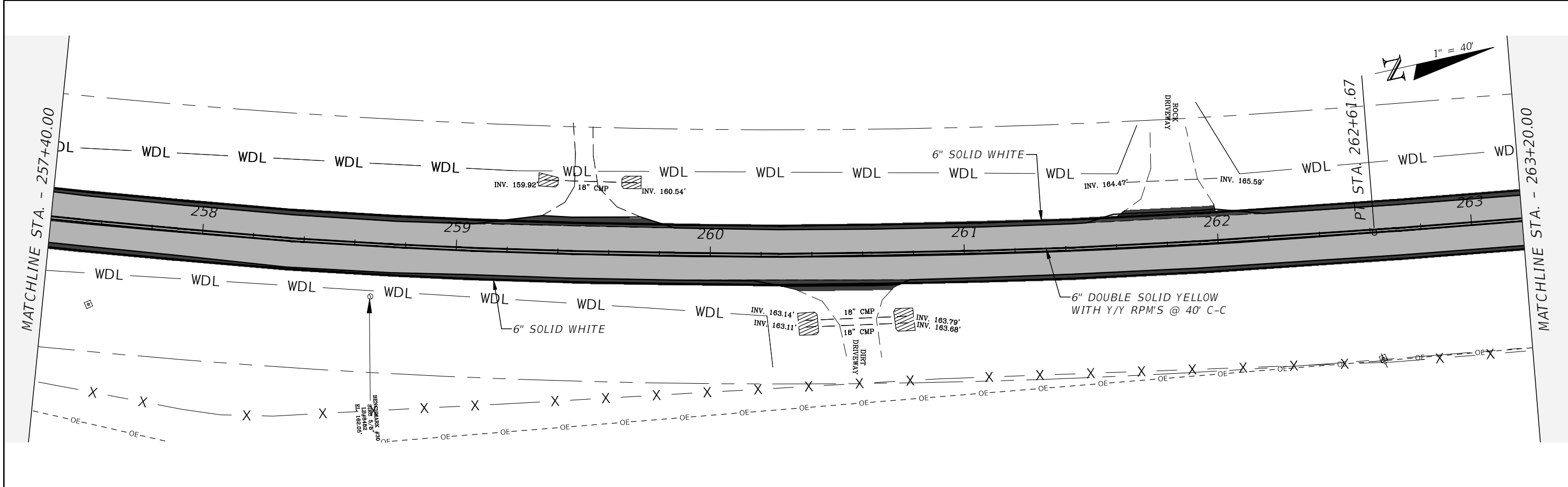
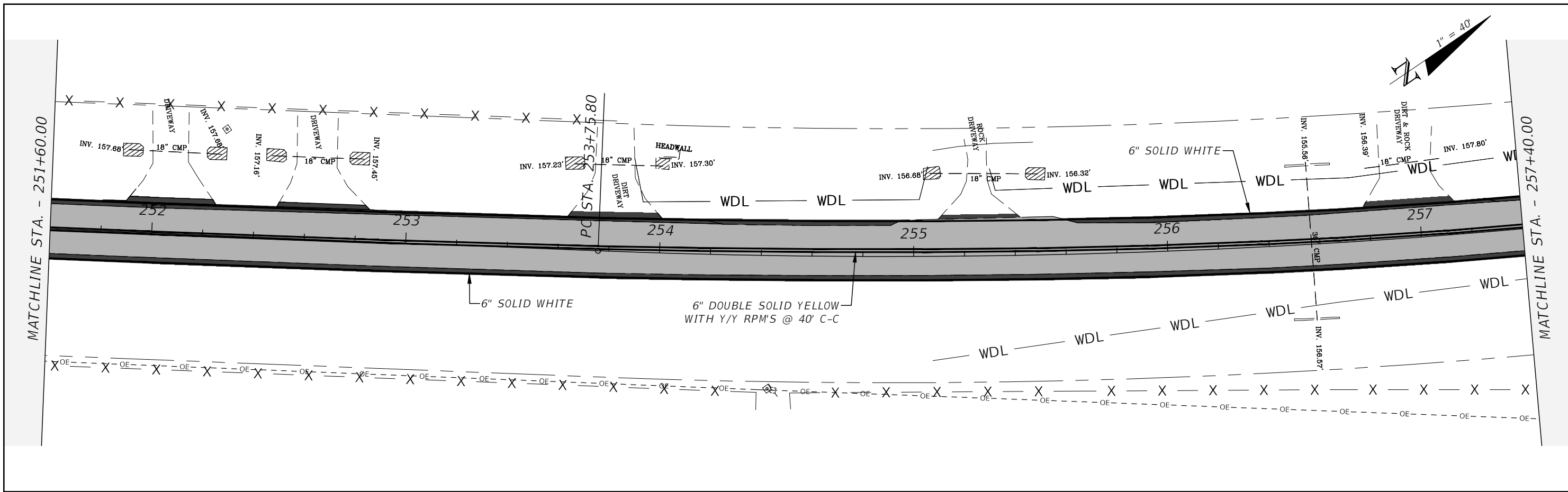

REVISIONS				LLOYD JACK HUSBAND, P.E. P.E. LICENSE NUMBER 69169 SCE, INC. 120 N. HWY 71 WEWAHITCHKA, FL 32456	STATE OF FLORIDA DEPARTMENT OF TRANSPORTATION			SIGNAGE & PAVEMENT MARKING PLAN	SHEET NO.
DATE	DESCRIPTION	DATE	DESCRIPTION		ROAD NO.	COUNTY	FINANCIAL PROJECT ID		
---	---	---	---		CR 149	JEFFERSON	448613-2-54-01		5-11

THE OFFICIAL RECORD OF THIS SHEET IS THE ELECTRONIC FILE DIGITALLY SIGNED AND SEALED UNDER RULE 61G15-23.004, F.A.C.

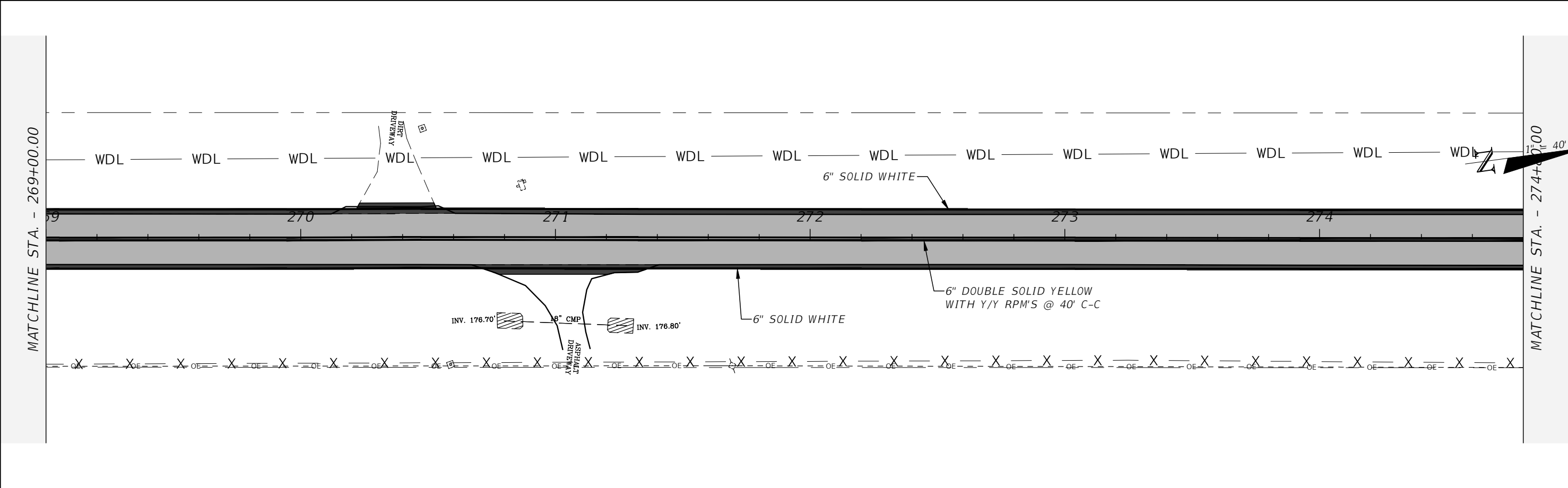
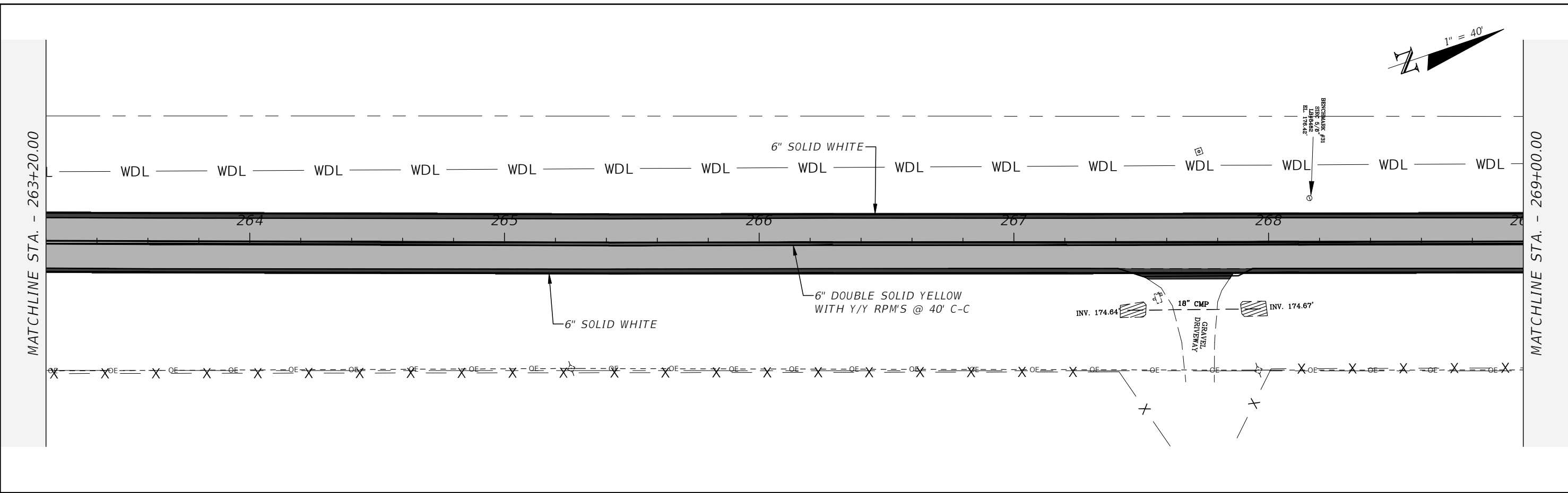
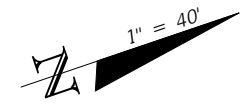

THE OFFICIAL RECORD OF THIS SHEET IS THE ELECTRONIC FILE DIGITALLY SIGNED AND SEALED UNDER RULE 61G15-23.004, F.A.C.

REVISIONS				LLOYD JACK HUSBAND, P.E. P.E. LICENSE NUMBER 69169 SCE, INC. 120 N. HWY 71 WEWAHITCHKA, FL 32456	STATE OF FLORIDA DEPARTMENT OF TRANSPORTATION			SHEET NO. 5-12
DATE	DESCRIPTION	DATE	DESCRIPTION		ROAD NO.	COUNTY	FINANCIAL PROJECT ID	
---	---	---	---		CR 149	JEFFERSON	448613-2-54-01	

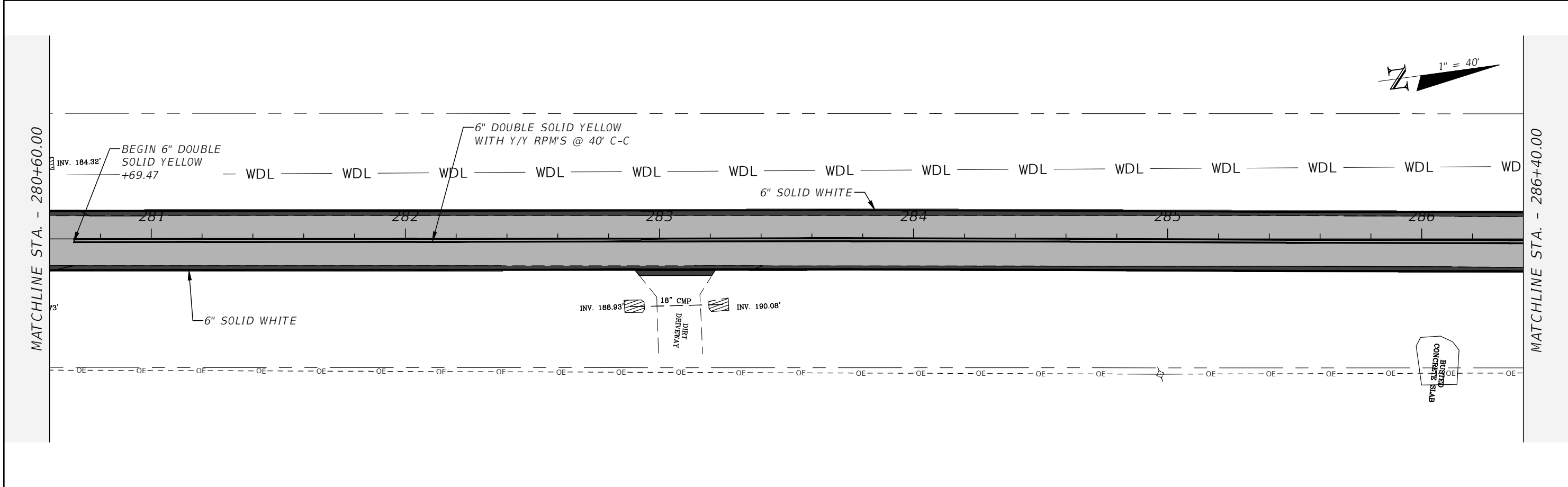
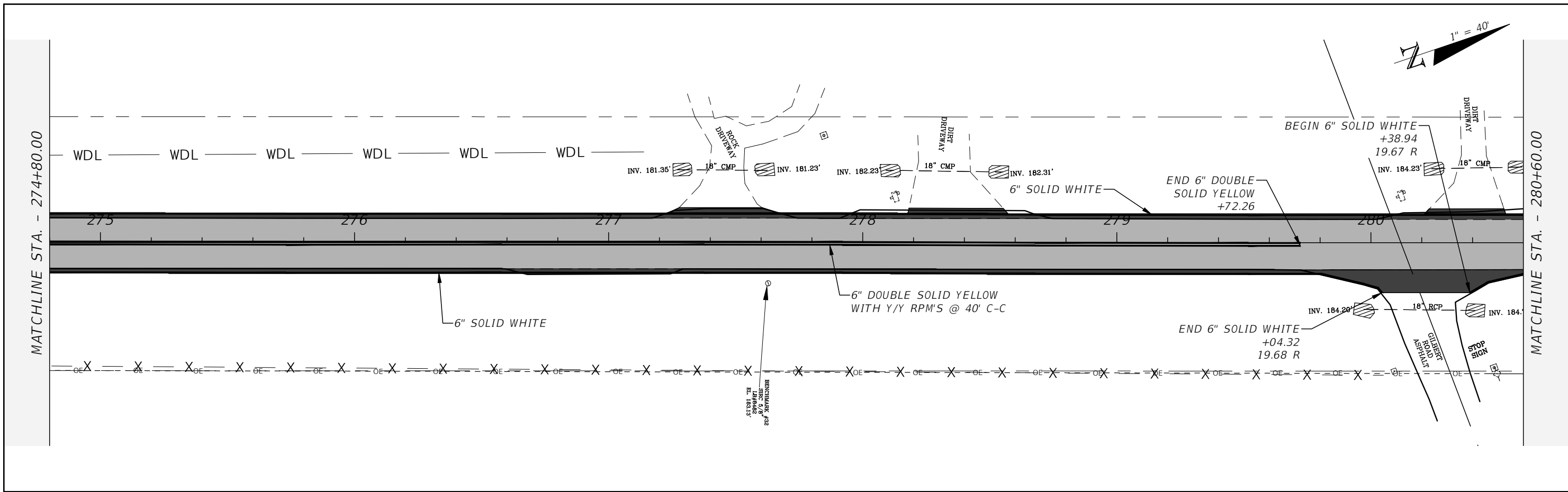

REVISIONS				LLOYD JACK HUSBAND, P.E. P.E. LICENSE NUMBER 69169 SCE, INC. 120 N. HWY 71 WEWAHITCHKA, FL 32456	STATE OF FLORIDA DEPARTMENT OF TRANSPORTATION			SIGNAGE & PAVEMENT MARKING PLAN	SHEET NO. 5-13
DATE	DESCRIPTION	DATE	DESCRIPTION		ROAD NO.	COUNTY	FINANCIAL PROJECT ID		
---	---	---	---		CR 149	JEFFERSON	448613-2-54-01		

THE OFFICIAL RECORD OF THIS SHEET IS THE ELECTRONIC FILE DIGITALLY SIGNED AND SEALED UNDER RULE 61G15-23.004, F.A.C.

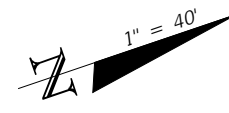

MATCHLINE STA. - 286+40.00

MATCHLINE STA. - 292+20.00

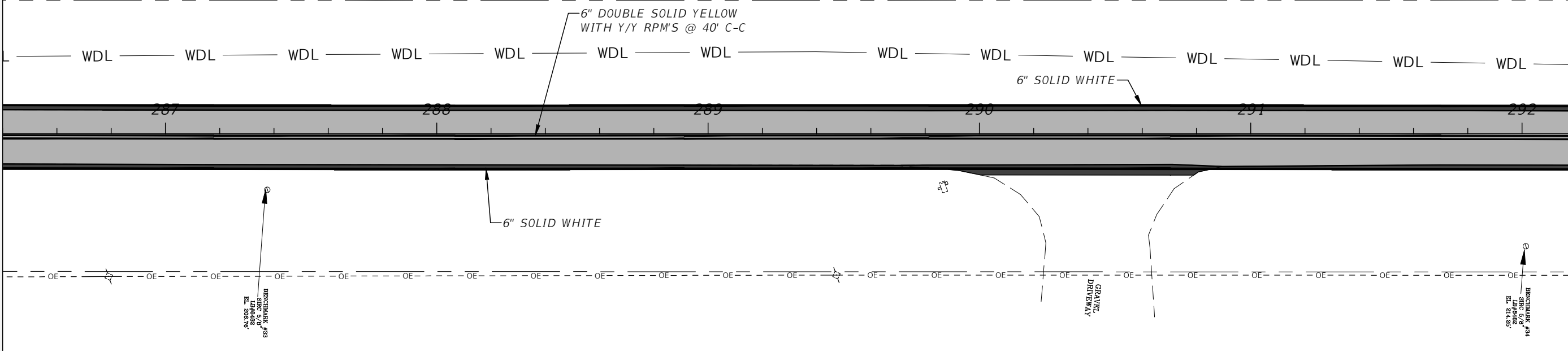

MATCHLINE STA. - 292+20.00

MATCHLINE STA. - 298+00.00

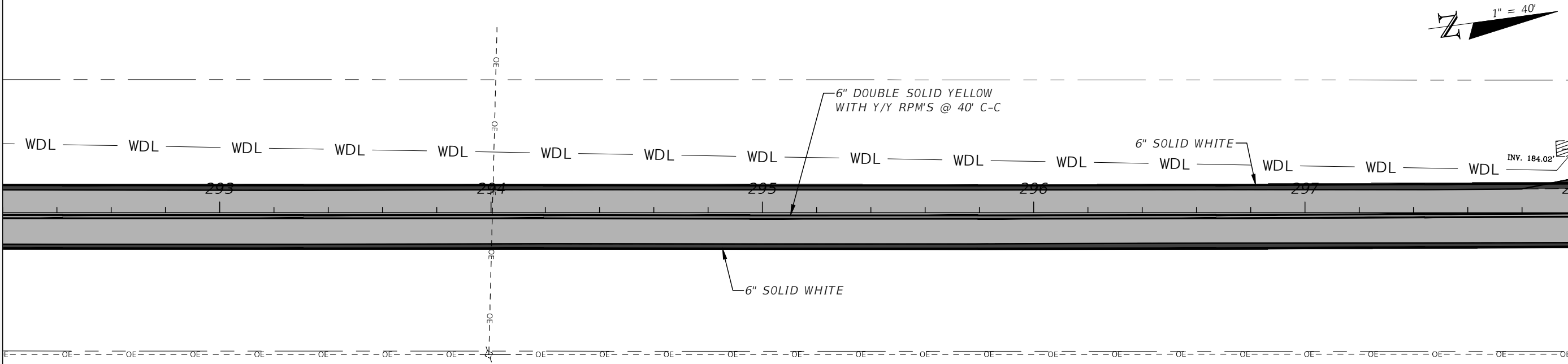

REVISIONS			
DATE	DESCRIPTION	DATE	DESCRIPTION

LLOYD JACK HUSBAND, P.E.
 P.E. LICENSE NUMBER 69169
 SCE, INC.
 120 N. HWY 71
 WEWAHITCHKA, FL 32456

STATE OF FLORIDA DEPARTMENT OF TRANSPORTATION		
ROAD NO.	COUNTY	FINANCIAL PROJECT ID
CR 149	JEFFERSON	448613-2-54-01

**SIGNAGE & PAVEMENT
MARKING PLAN**

SHEET
NO.
5-14

THE OFFICIAL RECORD OF THIS SHEET IS THE ELECTRONIC FILE DIGITALLY SIGNED AND SEALED UNDER RULE 61G15-23.004, F.A.C.

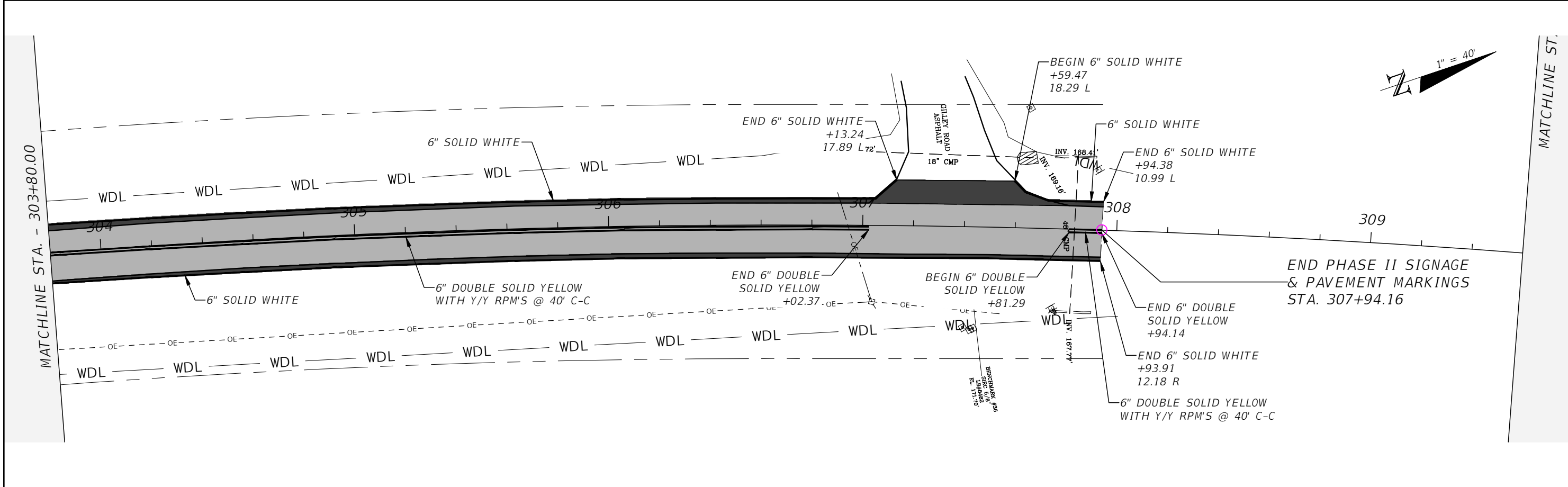
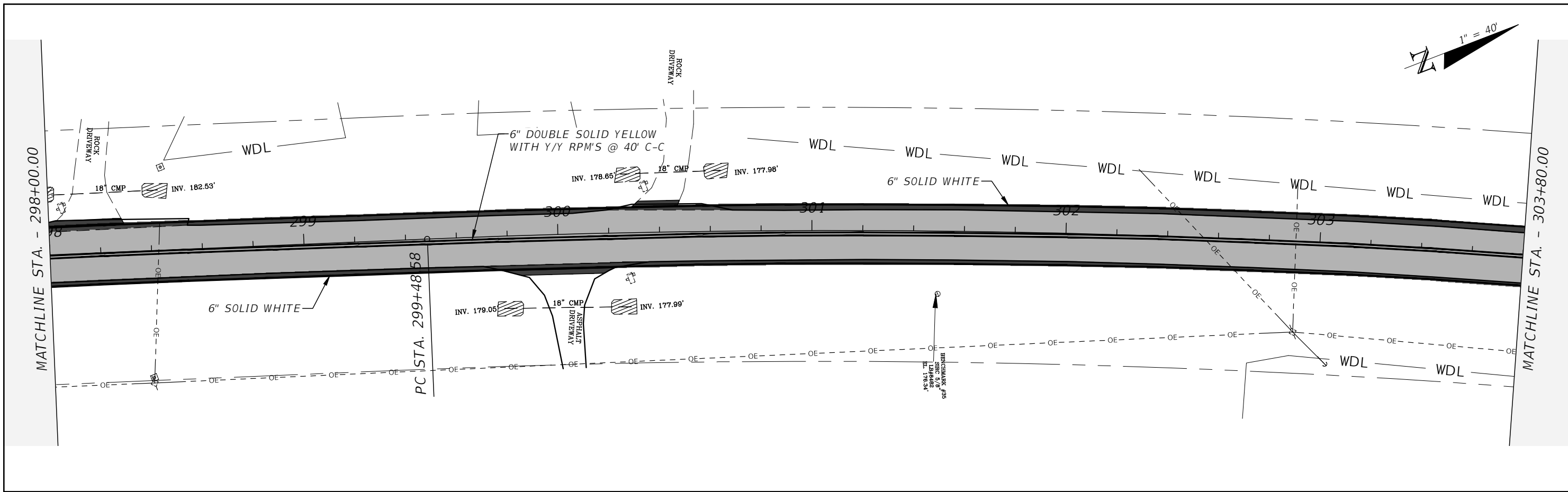

REVISIONS			
DATE	DESCRIPTION	DATE	DESCRIPTION

LLOYD JACK HUSBAND, P.E.
P.E. LICENSE NUMBER 69169
SCE, INC.
120 N. HWY 71
WEWAHITCHKA, FL 32456

STATE OF FLORIDA DEPARTMENT OF TRANSPORTATION		
ROAD NO.	COUNTY	FINANCIAL PROJECT ID
CR 149	JEFFERSON	448613-2-54-01

**SIGNAGE & PAVEMENT
MARKING PLAN**

SHEET NO.
5-15

THE OFFICIAL RECORD OF THIS SHEET IS THE ELECTRONIC FILE DIGITALLY SIGNED AND SEALED UNDER RULE 61G15-23.004, F.A.C.